

STATE
OF THE
LINCOLN
LUNATIC ASYLUM,

(Instituted November 4, 1819.)

~~~~~  
1843.  
~~~~~

LINCOLN:
PRINTED BY J. W. DRURY, HIGH-STREET.

CONTENTS.

	PAGES.
Annual Report	3
Officers, Trustees	9
Subscribers, Benefactors	10
Benefactors Deceased, Unknown, Public Bodies, &c	12
Legacies	14
Statement of the number of the Patients Admitted, and of those Discharged from the Books in 1842	15
Ditto, from the Opening of the Institution	15
State of the Patients when Discharged from the Books in 1842	15
Ditto, from the Opening of the Institution	15
Re-admitted Cases	15
Ditto, after apparent Recovery	15
Admissions, Recoveries, Deaths, and Causes of the Deaths in each year, from the Opening of the Institution	16
Periods of Decease after Admission in 1842	17
Ditto, from the Opening of the Institution	17
Ages at the time of Decease in 1842	17
Ditto, from the Opening of the Institution	17
Number of Deaths in each Month, from the opening of the Institution....	17
Weekly Return of the State of the Patients	18
Daily Return of the State of the Patients	19
Recoveries, as affected by the Duration of the Complaint before Admission	20
Results of the Cases Received in 1842, as found March 31st, 1843, showing the practice of the House	21
Disbursements and Receipts in 1842; and Statement of the Debts and Credits	22
Number of Patients Admitted in 1840, 1841, 1842, respectively	24
Payments of Patients on the Books in ditto	24
Number of each Rank of Patients Admitted in ditto	24
Payments of each Rank of Patients on the Books in ditto	24
Number and Payments of each Rank of Patients admitted or re-admitted, from the Opening of the Institution	24
Principal Provisions, &c., consumed in 1840, 1841, 1842, respectively...	25
Daily average number of Patients and Household in ditto	25
Daily average consumption of Bread and Meat per head, in ditto	25
Weekly average loss on Bread and Meat in ditto	25
Dietary	26
Articles of Work made up by the Female Patients	26
Airing Grounds, Apartments, Beds	26
Extracts from the Rules,	27
<i>viz</i> , Meetings of the Boards.	
Forms and Terms of Admitting Patients	
Visiting by Governors.	
Visiting by Strangers.	
Visiting by the Friends of the Patients.	
Form for Legacies	28

1843.

LINCOLN
LUNATIC ASYLUM.

NINETEENTH REPORT.

SINCE the publication of the last Annual Report, the situation of House Surgeon has become vacant by the retirement of Mr. William Smith, who has entered upon the duties of House Surgeon of the Lincoln County Hospital. Mr. William Graham has been appointed to succeed in the vacant office, and has given much satisfaction to the Board, and every promise of future usefulness.

The avoidance of Instrumental Restraint, as well as of Solitary Confinement, still continues; and a remarkable confirmation of the principle has occurred, from the circumstance of the Board having ordered a register to be kept of every instance of Manual Detention continued longer than ten minutes. The desperate struggle, which used to occur for the purpose of inflicting the instruments, might easily extend beyond ten minutes; and yet only three instances of manual detention to that extent, have been found necessary during twenty-four successive months. The Boards submitted to have their time occupied in listening to the evidence of persons, discharged for misbehaviour towards the Patients; who endeavoured to justify their own conduct by exaggerations and mistatements; and among other matters affirmed, that it had been necessary to subject the Patients to manual detention for days together.

On the resignation of the House Surgeon, the Board passed the following resolutions.

Dec. 5, 1842. Resolved, on the motion of Dr. Charlesworth, seconded by Mr. R. G. Hill,

“THAT this Board, on the retirement of Mr. William Smith, cannot omit the opportunity of expressing its acknowledgments, for his having conducted the personal management of the Patients of this house, without a single instance of personal restraint, and, at one period, under peculiar difficulties, from the want of adequate and experienced attendants.”

“THAT the best acknowledgments of this Board are due to Mr. William Smith, for his having latterly laid down and adopted in practice, the broad principle, that Solitary Confinement ought to be utterly abolished.”

During the year a question has arisen, as to the extent of authority over the Patients, vested in the medical department; and the General Board thought it right, under the circumstances, to set all such questions at rest for the future; and at the same time to negative a variety of malpractices in treatment, either very long disused in this house, or never introduced at all into the system pursued there; but yet not formally forbidden by any express order of the Board, and therefore remaining matters of opinion, or discretion, as regarded their employment.

Jan. 11, 1843. Resolved, on the motion of the Rev. W. M. Pierce, seconded by Sir Edward Ffrench Bromhead, Bart., V. P.

“THAT the practice of the Medical Officers of this house is not arbitrary, or wholly discretionary, but is to be exercised under the Rules and the Orders of the Board, and within such limits, and on such principles, as this Board shall define.”

“THAT the Board has always acted herein with the greatest reserve and caution, and not without reference to medical authority, and the results of medical experience in this house and elsewhere; and that the most ample latitude has been allowed to inquiry, and to the use of any tone of language and action, however hostile towards the Board, and the character and interests of the house.”

Resolved, on the motion of Sir Edward Ffrench Bromhead, Bart., V. P., seconded by Mr. C. F. Sutton,

“THAT, under the present circumstances, the Board thinks it proper to express its sentiments upon certain points of practice to be observed in this house.”

- 1 “THAT this Board disapproves and disallows the use of Fermented Drink, as part of the ordinary diet of the Patients, or under the plea of supporting strength during any employment; leaving, as heretofore, the widest discretion to the Medical Officer, in the use of wine and porter, for cases seeming specially to require the use thereof; and that this Board is fully determined to maintain the nutritious and substantial diet, substituted some years ago for the use of Fermented Drink.”
- 2 “THAT this Board is more and more confirmed in its reprobation of Instrumental Restraint, and in its previously expressed opinion to estimate the competency of its Officers, by the disposition shown to avoid the use of Instruments and other violent processes, and to avoid Seclusion as a means of coercion.”
- 3 “THAT the introduction into this house, of the ‘Whirling Chair,’ the ‘Bath of Surprise,’ the ‘Douche,’ and other such violent and abrupt practice towards the Patients, is hereby interdicted.”
- 4 “THAT no system of warming this house, by which the Patients may breathe a heated atmosphere, be introduced.”
- 5 “THAT the practice of ‘Shaving the heads’ of Lunatics, ‘Blood-letting,’ the ‘Cold Bath,’ ‘Baths above blood heat,’ the process of subduing violence by the use of ‘Tartarised Antimony’ or of ‘Narcotics,’ the practice of enforcing sleep by Opiates, and courses of Drastic Medicines, are hereby interdicted, except in special cases otherwise medically requiring the same.”

“A Letter from the late House Surgeon, having been read as follows,”

LINCOLN LUNATIC ASYLUM, JAN. 11, 1843.

Gentlemen,

I cannot take leave of your invaluable Institution, in which I shall never cease to feel the deepest interest, without

reconsidering an opinion I have lately entertained, of a benefit from Stimulants, in the ordinary diet of the Insane. A more mature experience of the practice of this house, aided by careful inquiries and the practical views of many well informed persons, has convinced me that stimulating drink (except there should be any special cases medically requiring it) must further exhaust the already impaired nervous system of the Insane; and that the surest means of restoring and sustaining a healthy tone, will be found in nutritious aliment, fresh air, warm clothing, dry lodging, and other means of the same nature well known in this house. I will venture to express my belief that the substantial nutritious dietary of the Lincoln Asylum, is not surpassed in any other public Asylum in this kingdom;—and, while I contemplate the spacious Day rooms, warmed with open fires kept up throughout the summer months, when the season is cold or damp; the broad extensive Galleries for exercise in wet weather; the Boarded floors in every room throughout the house; the cheerful Grounds and ample Courts; the total abolition of the depressing influence of Instrumental Restraint, and of Solitary Confinement as an alternative; with other notable improvements, in which this Institution has taken so conspicuous a lead; I would respectfully deprecate any attempt at returning to the system of Stimulants, and the withdrawal of the increased allowance of Animal Food, so happily substituted in this place.

I have the honor to remain, Gentlemen,

Your faithful and obedient Servant,

WM. SMITH, House Surgeon.

Resolved,—“THAT the same be entered on the Minutes, and that Mr. Smith be thanked for his communication.”

The improvements in the treatment of the Insane, have heretofore been more in the general economy of their management, and the negating injurious practices, than in any positive medical means; which must generally depend upon the source of the disease in each case. The greatest benefits however have arisen from the clear stage thus left to nature, under a careful attention to the general health. It is quite remarkable to observe

how a regular and sober general management, tends to diminish all the more striking evils, which are so prominent in these institutions; and which render the management in such cases so painful and so very difficult. The evils assume a milder and more manageable form, or almost wholly melt away without any very defined reason, under a sound general economy; though the greatest efforts and most ingenious expedients had previously been resorted to in vain. Such inconveniences must however more or less exist at all times; and it would be of great public benefit to collect into one focus and publish, all the minor contrivances, which experience has suggested for meeting these difficulties. It is hoped that the Medical department, and the Board of this Asylum, will endeavour to accumulate materials on these points for future reports; and it is not improbable that other heads may occur to them, not enumerated among the following.

- 1 Excitement and violence.
- 2 Insomnolence.
- 3 Noisiness.
- 4 Abusive, profane, and obscene language.
- 5 Mischievous tricks, tearing cloths, undressing, &c.
- 6 Treachery.
- 7 Suicidal propensities.
- 8 Refusing food.
- 9 Depraved appetites for food.
- 10 Depressing habits.
- 11 Irretention by the bowels.
- 12 Irretention by the bladder.
- 13 Bedridden.
- 14 Crippled.
- 15 Sinking, and extreme debility.
- 16 Fits.

The practice of Monthly Assemblies for the amusement of the Insane during the Winter Season, seems to be extending to other Institutions; and it may therefore be worth while to mention, that the comparative dullness of the male side of the house on these occasions, has been removed by the introduction of Female Children, who appear to enjoy much joining in these dances, and apparently with less fear than any other persons of their own sex, who may

be present. Dr. Pritchard's able Report of the Northampton Asylum, just issued, mentions that there the time for closing the scene is announced by the National Anthem.

The Board has been desirous that the Tables, appended to their Reports, should be as full, accurate, and candid as possible. These are actually necessary to elucidate the true state of the house, and the statistical results of practice. Every Board honestly desirous to serve the public, and advance this most important branch of science, will fearlessly and unhesitatingly state the real facts, without any attempt to soften appearances, totally relying on upright intentions. Suicides should not be disguised under other names; and on this point the Board has been most scrupulous. The cases of Recovery should not be exaggerated, nor the proportion of deaths mystified, by any loose statement affecting the amount of Re-admissions. The Accounts should invariably be furnished, as indicating the general economy of the house, and numerous points of treatment, the scale and rate of expenditure of the Household, and the amount of property wasted under the guise of profitable employment, requiring increased capital, and enhancing the rates of charge. The Tables should also be retrospective, fairly indicating either progress or regression in the management, and offering very valuable statistical results, for drawing general conclusions. Publicity and the public eye, reaching every recess of the establishment, are the only ground to be permanently depended upon, against the growth of errors and abuses. Every false step (and the best intentions may make many) which may be kept back from the public, is a beacon and warning lost to other establishments.

The attention of the Governors is requested to a new table, adopted with variations from the noble national establishment at Hanwell, forming a return of the daily state of the Patients.

G. BROOKS,

CHAIRMAN.

June 5th, 1843.

OFFICERS.

President,

The Right Honorable the EARL of YARBOROUGH.

Vice-Presidents,

The Right Honorable the EARL BROWNLOW, *F. R. S.*

The Right Honorable the EARL of RIPON.

The Rev. Sir CHARLES JOHN ANDERSON, Bart.

Sir GILBERT HEATHCOTE, Bart. *M. P.*

Sir WILLIAM AMCOTTS INGILBY, Bart.

Sir WILLIAM EARLE WELBY, Bart.

Sir EDWARD FFRENCH BROMHEAD, Bart. *F. R. S.*

The Very Rev. GEORGE GORDON, *D. D.*, Dean of Lincoln.

The Rev. RICHARD PRETYMAN, Precentor of Lincoln.

CHARLES CHAPLIN, Esq.

CHARLES D. W. SIBTHORP, Esq., *M. P.*

ROBERT VYNER, Esq.

Treasurer,

JOHN FARDELL, Esq. *F. A. S.*

Auditors,

JAMES SNOW, Esq.—Mr. G. BROOKS.

Physicians,

E. P. CHARLESWORTH, *M. D.*

W. D. COOKSON, *M. D.*—RICHARD ELMHIRST, *M. D.*

Surgeons,

Mr. SNOW.—Mr. HEWSON.—Mr. HOWITT.

HOUSE-SURGEON, Mr. W. GRAHAM—MATRON, Miss A. VESSEY.

SECRETARY, Mr. J. WILSON.—SURVEYOR, Mr. J. YOUNG.

Trustees of the Real Estate,

The Very Rev. GEORGE GORDON, *D. D.*

CHARLES MAINWARING, Esq.

ANNUAL SUBSCRIBERS.

☞ An Annual Subscription of three Guineas constitutes a Governor.—Subscriptions are payable in advance on the *first day of January* yearly, and are received by the Treasurer, or Secretary, or at the Asylum, or at the Lincoln Bank.

Those having this mark () are Benefactors by Donation also.*

	£	s.	d.		£	s.	d.
*Brooks, Mr. G. Lincoln	4	0	0	Monson, Rt. Hon. Lord, Burton	3	3	0
*Brownlow, Earl, <i>V. P.</i> Belton	10	0	0	Moore, Rev. W. <i>D. D.</i> Spalding	1	1	0
Christopher, Mr. <i>M. P.</i> Bloxholm	3	3	0	Pacey, Rev. H. B. <i>D. D.</i> Aston			
Claypon, Mrs. Joseph . . . Boston	1	1	0	House, near Stevenage, Herts.	3	3	0
Claypon, Mr. B. jun . . . Boston	1	1	0	Penrose, Miss Coleby	1	1	0
Clifford, Hon. C. T. Irnham Hall	1	1	0	*Pretyman, Rev. R. Lincoln	5	5	0
*Cracroft, Colonel . . Hackthorn	5	5	0	Rogers, Mr. H. Boston	3	3	0
*Doncaster, Rev. Dr. . . Oakham	2	2	0	Sibthorp, Rev. H. W. Washingbro'	3	3	0
Ellison, Mr. . . Sudbrooke Holme	5	5	0	*Smith, Mr. B. Horbling	2	2	0
Fox, Rev. W. Girsby House	2	2	0	Smyth, Rev. E. South Elkington	1	1	0
Golden, Mr. Caenby Hall	3	3	0	Walls, Rev. J. Boothby	1	1	0
Harnage, Mrs. Lincoln	3	3	0	Wilson, Mr. John Lincoln	1	1	0
Hickman, Mr. . . Thonock Grove	3	3	0	*Yarborough, Right Hon. Earl,			
Hill, Mr. R. G. Lincoln	3	3	0	PRESIDENT . . Brocklesby	21	0	0
Jarvis, Rev. C. M. G. Doddington	1	1	0	Yeadon, Rev. W. . Waddington	1	1	0
*Johnson, Mr. T. F. . . Spalding	1	1	0				

BENEFACTORS.

☞ A Benefaction of twenty Guineas, at one or two payments, constitutes a Life Governor.—Benefactions are received by the Treasurer, or Secretary, or at the Asylum, or at the Lincoln Bank.

Those marked thus () are Annual Subscribers also.*

	£	s.	d.		£	s.	d.
Allison, Mr. W. Louth	52	10	0	Burton, Mr. Somersby	21	0	0
Anderson, Rev. Sir C. J. Bart.				Calthrop, Mr. . . Stanhope Hall,			
<i>V. P.</i> Lea	31	0	0	Lynn	25	0	0
Andrews, Mr. H. Wakefield	10	0	0	Carline, Mr. Lincoln	21	0	0
Atkinson, Mr. M. Lincoln	10	0	0	Cayley, Sir George, Bart. Brompton	42	0	0
Barton, Dr. Market Rasen	21	0	0	Chaplin, Mr. <i>V. P.</i> . . Blankney	100	0	0
Bassett, Rev. H. Glentworth	5	0	0	Charlesworth, Dr. . . . Lincoln	21	0	0
Bayley, Ven. Arch. for 'a Friend'	100	0	0	Ditto, for a Lady unknown	10	0	0
Beaty, Dr. for a person unknown	30	0	0	Clark, Rev. H. Harmston	5	5	0
Benson, Rev. H. B. Utterby	21	0	0	Collet, Mr. The Jungle	5	0	0
Bernal, Mr. <i>M. P.</i> London	50	0	0	Collet, Mrs. Ditto	5	0	0
Bonney, Ven. Arch. Normanton	5	5	0	Colton, Mrs. Sarah Lincoln	21	0	0
Bonney, Ven. Arch. Nassington	5	5	0	Cookson, Rev. C. . . . Stamford	5	5	0
Boucherett, Mr. Willingham				Cookson, Dr. Lincoln	21	0	0
House	21	0	0	Cooper, Rev. W. . . . West Rasen	5	5	0
Bouverie, Rev. Mr.	7	0	0	Conington, Rev. J. . . . Navenby	21	0	0
Brackenbury, Lieut. Colonel, Sir				Corbett, Mr. Elsham Hall	21	0	0
Edward, <i>K. T. S.</i> Skendleby	21	0	0	Coxe, Rev. G. . . Twyford, near			
Brailsford, Mr. Toft	21	0	0	Winchester	21	0	0
Bromhead, Sir E. F. Bart., <i>V. P.</i>				*Cracroft, Colonel . . . Hackthorn	5	5	0
Thurlby Hall	40	0	0	Curtois, Rev. P. . . . Longhills	21	0	0
*Brooks, Mr. G. Auditor,				Cust, Hon. William London	30	0	0
Lincoln	25	0	0	Cust, Hon. and Rev. R. . . Belton	10	0	0
Brown, Mr. F. Welbourne	5	0	0	Dent, Mr. Ribston Hall	25	0	0
Brown, Captain H. Lincoln	21	0	0	*Doncaster, Rev. Dr. . . Oakham	10	0	0
*Brownlow, Earl, <i>V. P.</i> Belton	150	0	0				

	£	s.	d.		£	s.	d.
Durham, Rt. Rev. Edw. Maltby, Lord Bishop of	21	0	0	Magistrates of the Louth and Spilsby Division, their wages for the years 1836—37—38			
Elmhirst, Colonel, Stainton Hall	21	0	0	39—40—41	102	19	0
Elmhirst, Dr. Lincoln, for a person unknown	22	0	0	Mainwaring, Mr. ... Coleby Hall	52	10	0
Empson, Mrs. Sarah	21	0	0	Mason, Mr. R. Lincoln	21	0	0
Fardell, Mr. <i>Treasurer</i> , Lincoln	50	0	0	Massey, Mr. J. B. being a ser- vant's wages forfeited by			
Farmer, Rev. Mr. London	5	5	0	misconduct	5	0	0
Farr, Mr. F. Minting	10	10	0	Mawley, Mr. Robert .. London	5	0	0
Fowler, Mr. Ald. E. Lincoln	21	0	0	Merryweather, Mr. J. ... Lincoln	21	0	0
Frederick, Sir R. Bart. Burwood Park, Surry	21	0	0	Newcomb, Messrs. Stamford	10	0	0
Freke, the Lady Sophia, Glaston House	25	0	0	Norton, Mr. Lincoln	5	0	0
Fydell, Mr. S. R. Tickencote	100	0	0	Otter, Mr. Robert	25	0	0
Garfit, Mr. J. Boston	10	10	0	Otter, Miss A. Wath	25	0	0
Garfit, Mr. W. Boston	10	10	0	Overton, Mr. J. S. ... Horncastle	5	5	0
Glasier, Mr. S. Hykeham	5	5	0	Pacey, Miss M. A. Bath	21	0	0
Gleed, Mr. R. Donington	15	15	0	Padley, Mr. J. S. Lincoln	21	0	0
Goodenough, Ven. Archdeacon, Mareham	21	0	0	Pearson, Rev. Dr. ... S. Kilworth	10	10	0
Gordon, Very Rev. G. <i>D. D.</i> Dean of Lincoln, <i>V. P.</i> ...	100	0	0	Penrose, Rev. J. Langton	5	0	0
Hadwen, Mr. Lincoln	21	0	0	Pierce, Rev. W. M. West Ashby	21	0	0
Hall, Rev. Mr. Westborough	5	5	0	Potchett, Rev. W. ... Grantham	5	5	0
Harrison, Mr. ... Toilethorpe Hall	10	0	0	Pretyman, Rev. G. T. Chancellor of Lincoln	25	0	0
Harrowby, Earl of London	50	0	0	*Pretyman, Rev. R. Precentor of Lincoln, <i>V. P.</i>	25	0	0
Hartley, Mr. J. Lincoln	21	0	0	Raby, Rev. C. Grantham	21	0	0
Harvey, Mr. R. S. ... Lincoln	21	0	0	Recve, General ... Lcadenham	21	0	0
Healey, Mr. H. High Risby	26	0	0	Reynardson, General, Holywell	20	0	0
Heathcote, Sir Gilbert, Bt. <i>V. P.</i> Normanton	100	0	0	Ripon, Right Hon. Earl of, <i>V. P.</i> Nocton	26	0	0
Heneage, Mr. Hainton Hall	21	0	0	Rudgard, Mr. E. W. R. Lincoln	21	0	0
Henson, Mr. Cheseldon, Bainton	5	0	0	Shepherd, Mrs. Eliz. Donington	10	10	0
Hickson, Miss E. Lincoln	5	0	0	Sibthorp, Colonel, <i>M. P. V. P.</i> Canwick	25	0	0
Higgins, Mr. J. Alford, for a person unknown	21	0	0	Skipworth, Mr. G. Morton Hill	21	0	0
Ditto, a penalty paid to him ...	5	5	0	Skipworth, Mr. W. ... S. Kelsey	5	0	0
Hobart, Hon. and Very Rev. Henry Lewis, <i>D. D.</i> Dean of Windsor	10	10	0	*Smith, Mr. B. Horbling	21	0	0
Hutton, Mr. H. W. ... Beverley	21	0	0	Smith, Mr. G. Spilsby	5	0	0
Ingilby, Sir William, Bart. <i>V. P.</i> Ripley Park	50	0	0	Snow, Mr. <i>Auditor</i> , for a Lady	21	0	0
Jarvis, Colonel, Doddington Hall	21	0	0	Steel, Mr. Lincoln	26	5	0
*Johnson, Mr. T. F. ... Spalding	10	10	0	Strong, Ven. Archdeacon, <i>D. D.</i> Peterborough	10	10	0
Kendal, Rev. J. Rector of Bar- rowby, near Grantham ...	10	10	0	Summers, Mr. Eades, Fangrove Lodge, Chertsey, Surry ...	100	0	0
Kent, Rev. G. D. for a Lady desiring to be unknown ..	50	0	0	Sutton, Sir R. Bart. ... Lincoln	50	0	0
Kingston, Mrs. Boston	5	0	0	Sutton, Rev. Thomas Manners, Subdean of Lincoln	25	0	0
Lee, Mrs. Bath	5	5	0	Sutton, Mr. C. F. Wragby	21	0	0
Lincoln, Right Rev. John Kaye, Lord Bishop of	25	0	0	Swan, Rev. F. Lincoln	51	0	0
Loft, Mr. Grainthorp	21	0	0	Swan, Mr. R. Lincoln	21	0	0
Lyon, Miss	5	0	0	Ditto, for a Lady	10	0	0
Mackinnon, Rev. J. Bloxholm, for "A Friend"	21	0	0	Swan, Mr. Joseph	5	0	0
				Thorold, Mr. Cuxwold	21	0	0
				Thynne, the Right Hon. and Rev. Lord John	25	0	0
				Turnor, Mrs. ... Stoke Rochford	10	0	0
				Turnor, Mr. John	20	0	0

	£	s.	d.		£	s.	d.
Twigge, Rev. F. F. . . . S. Kelsey	10	10	0	Willoughby de Broke, Lord . .	50	0	0
Vyner, Mr. V. P. Gautby House	100	0	0	Willson, Mr. William . . London	5	0	0
Watkins, Rev. H. Rector of Waltham	5	5	0	Willson, Rev. J.	31	0	0
Welby, Sir William Earle, Bart. V. P. Denton	40	0	0	Winchilsea, Earl of, Haverholm Priory	25	0	0
Welby, Miss Balderton	5	5	0	Winn, Mr. Thomas Lincoln	21	0	0
Welfit, Mr. Manby Hall	21	0	0	Wood, Mr. Ald. T. . . . London	5	0	0
Welfit, Mr. Pilham	5	0	0	Worsley, Rt. Hon. Lord, M. P. Manby	21	0	0
Welfit, Mrs. Ditto	5	0	0	Wright, Mr. . . Brattleby House	41	0	0
Wetherhead, Rev. J. Doncaster	5	5	0	Wright, Miss . . Brattleby House	21	0	0
White, Mr. George, Grantham	51	0	0	Wright, Rev. W. Healing	25	15	0
White, Mr. W. H. . . . London	21	0	0	Wyles, Mr. Little Ponton	10	0	0
White, Mr. Charles	5	0	0	*Yarborough, Right Hon. Earl, PRESIDENT Brocklesby	300	0	0
Williams, Hon. Mr. Justice . . .	50	0	0				

~~~~~

BENEFACTORS DECEASED, UNKNOWN, PUBLIC BODIES, &c.

|                                                  | £   | s. | d. |                                                                     | £   | s. | d. |
|--------------------------------------------------|-----|----|----|---------------------------------------------------------------------|-----|----|----|
| Ainsley, Sir R. Bart. Torrington                 | 5   | 5  | 0  | Cawthorne, Mr. J. F. Lancaster                                      | 10  | 0  | 0  |
| Allenby, Mr. Charles, Horncastle                 | 10  | 10 | 0  | Chaplin, Mr. . . . . Blankney                                       | 100 | 0  | 0  |
| Ancotts, Lady . . . . Harrington                 | 20  | 0  | 0  | Charlesworth, Rev. J. Ossington                                     | 5   | 5  | 0  |
| Ancaster, Duke of, Grimsthorpe                   | 100 | 0  | 0  | Cheales, Mr Benjamin, Sleaford                                      | 25  | 0  | 0  |
| "Anonymous," by the Rev. C.<br>Nevile . . . . .  | 2   | 10 | 0  | Cholmeley, Sir. M. Bart. Easton                                     | 21  | 0  | 0  |
| Barnard, Mr. Samuel . . Boston                   | 21  | 0  | 0  | Cholmeley, Lady, Norton Place                                       | 5   | 0  | 0  |
| Bartholomew, Mr. T. . . . Langton                | 5   | 5  | 0  | Cholmeley, Miss . . . . Oxford                                      | 5   | 0  | 0  |
| "Benefactor" by C. . . . .                       | 5   | 5  | 0  | Coltman, Mr. . . Hagnaby House                                      | 100 | 0  | 0  |
| Bernard, Sir T. Bart. . . London                 | 21  | 0  | 0  | Coltman, Rev. J. . . . . Beverley                                   | 10  | 10 | 0  |
| Berridge, Rev. B. B. . . Algakirk                | 26  | 5  | 0  | Colton, Mr. Alderman . . Lincoln                                    | 21  | 0  | 0  |
| Birch, Colonel . . . . Thorpe Hall               | 10  | 10 | 0  | Conington, Mr. . . . . Horncastle                                   | 15  | 0  | 0  |
| Bosville, Rev. T. Rector of<br>Heapham . . . . . | 21  | 0  | 0  | Cookson, Dr. . . . . Lincoln                                        | 21  | 0  | 0  |
| Bower, Mr. Anthony . . . Lincoln                 | 5   | 0  | 0  | Craeroft, Rev. B. . . . Rippingale                                  | 7   | 7  | 0  |
| Brackenbury, Mr. C. . . Scrembly                 | 15  | 0  | 0  | Crane, Dr. from the friends of the<br>late Dr. Knolton . . . Boston | 23  | 13 | 0  |
| Brackenbury, Mrs. E. . . Lincoln                 | 5   | 0  | 0  | Curtois, Rev. P. H. . . . Branston                                  | 10  | 10 | 0  |
| Brackenbury, Mr. R. C. Raithby                   | 20  | 0  | 0  | Dalton, Mr. . . . . Knaith House                                    | 26  | 5  | 0  |
| Brand, Rev. Mr. . . Sigglethorpe                 | 10  | 10 | 0  | Dalton, Colonel . . Slaniford Hall                                  | 25  | 0  | 0  |
| Brittain, Mr. . . . . Sleaford                   | 5   | 5  | 0  | Darwin, Mr. . . . . Sleaford                                        | 5   | 0  | 0  |
| Broadbent, Rev. Mr. Billingham                   | 5   | 5  | 0  | Deaeon, Rev. J. R. Waddington                                       | 21  | 0  | 0  |
| Broadley, Mrs. . . . Blyborough                  | 21  | 0  | 0  | Deacon, Miss S. . . . Waddington                                    | 15  | 0  | 0  |
| Bromhead, Mrs. B. . . . Lincoln                  | 25  | 0  | 0  | Drake, Mr. T. D. Tyrwhit . . .                                      | 50  | 0  | 0  |
| Bromhead, Rev. E. . . . Repham                   | 25  | 0  | 0  | Drake, Mrs. . . . . Lincoln                                         | 5   | 0  | 0  |
| Bromhead, Colonel . . . Lincoln                  | 10  | 10 | 0  | Durance, Rev. W. . . . . Lincoln                                    | 5   | 5  | 0  |
| Bromhead, Mrs. Col. . . Lincoln                  | 10  | 0  | 0  | Eardley, Lord . . . . .                                             | 105 | 0  | 0  |
| Bromhead, Mrs. B. . . . Lincoln                  | 25  | 0  | 0  | Ellis, Rev. Dr. . . . . Leadenham                                   | 10  | 10 | 0  |
| Bromhead, Col. John . . Lincoln                  | 10  | 10 | 0  | Ellis, Rev. J. . . . . Branston                                     | 13  | 10 | 0  |
| Brown, Mr. Hezekiah . . Lincoln                  | 21  | 0  | 0  | Ellison, Mr. . . . . Lincoln                                        | 10  | 10 | 0  |
| Brown, Rev. Broxholm, Lincoln                    | 5   | 5  | 0  | Ellison, Lieut. Col. . . . Sudbrook                                 | 50  | 0  | 0  |
| Brown, Rev. T. . . . . Leadenham                 | 21  | 0  | 0  | Elsdale, Rev. Samuel. . Moulton                                     | 18  | 11 | 0  |
| Brownlow, Earl. . . . . Belton                   | 100 | 0  | 0  | Ditto, on account of three<br>Editions of Poems . . . . .           | 52  | 10 | 0  |
| Buckinghamshire, Earl of . . .                   | 40  | 0  | 0  | Emeris, Rev. J. . . . . Louth                                       | 10  | 10 | 0  |
| Buckworth, Mesdames, Stamford                    | 50  | 0  | 0  | Fairfax, Mr. J. . . . . Newton Kyme                                 | 15  | 15 | 0  |
| Burcham, Mr. . . . . Coningsby                   | 21  | 0  | 0  | Farr, Mr. T. . . . . Beckingham                                     | 5   | 5  | 0  |
| Burton, Mr. Robert. . . Lincoln                  | 101 | 0  | 0  | Featherby, Mr. Ald. W. Lincoln                                      | 23  | 2  | 0  |
| Caparn, Rev. J. . . . . Boston                   | 5   | 5  | 0  | Ditto, for Convictions, &c. . . . .                                 | 11  | 13 | 0  |
| Carter, Rev. J. . . . . Lincoln                  | 5   | 5  | 0  | Featherby, Mr. Ald. R. Lincoln                                      | 23  | 2  | 0  |

|                                    | £   | s. | d. |                                      | £   | s. | d. |
|------------------------------------|-----|----|----|--------------------------------------|-----|----|----|
| Ditto, for Convictions, &c. ....   | 11  | 13 | 6  | Lincoln, Dean and Chapter of         |     |    |    |
| Flowers, Rev. F. .... Boston       | 5   | 0  | 0  | 1807, viz—                           |     |    |    |
| Forsyth, Mr. T. ... Empringham     | 21  | 0  | 0  | Late Rev. Sir R. Kaye, Bt. } 100 0 0 |     |    |    |
| Fosters, Messrs. C. & T. Lincoln   | 5   | 0  | 0  | Late Rev. Archd. Pretyman, } 100 0 0 |     |    |    |
| Fothergill, Rev. J. .... Gainsbro' | 5   | 5  | 0  | Late Rev. Archh. Wharton, } 100 0 0  |     |    |    |
| Fowler, Mrs. M. D. .... Lincoln    | 10  | 10 | 0  | Rev. Archd. Bayley, D. D. }          |     |    |    |
| Fowler, Rev. R. Warboys, Hunts     | 5   | 5  | 0  | Lincoln Cathedral, Organist and      |     |    |    |
| Fowler, Mr. Ald. Robt. Lincoln     | 21  | 0  | 0  | Lay Vicars of, 1807. ....            | 5   | 5  | 0  |
| Fretwell, Rev. J. .... Raithby     | 5   | 5  | 0  | Lincoln, Corporation of, 1807..      | 100 | 0  | 0  |
| "Friend to the afflicted" ....     | 5   | 5  | 0  | Lindsey, Earl of. .... Uffington     | 50  | 0  | 0  |
| Gordon, Rev. J. ... Edwinstow      | 31  | 10 | 0  | Lister, Mr. .... Burwell Park        | 631 | 10 | 0  |
| Goulton, Mr. Thomas .. Walcot      | 50  | 0  | 0  | Lister, Mr. .... Girsby House        | 25  | 0  | 0  |
| Graburn, Mr. M. Nelson, Barton     | 10  | 10 | 0  | Litchford, Rev. J. R. ... Boothby    | 20  | 0  | 0  |
| Graburn, Mr. William, Barton       | 10  | 10 | 0  | Littlehales, Rev. V. P. ....         | 10  | 10 | 0  |
| Grant, Mr. William ... Oxcomb      | 5   | 0  | 0  | Loft, Mr. .... Louth                 | 21  | 0  | 0  |
| Green, Mr John ... Welbourne       | 10  | 10 | 0  | Maddison, Mr. J. .... Bath           | 21  | 0  | 0  |
| Gwydir, Lord ... Grimsthorpe       | 105 | 0  | 0  | Maddison, Rev. G. ....               | 5   | 5  | 0  |
| Handley, Mr. Benjamin, Sleaford    | 21  | 0  | 0  | Magistrates of the neighbourhood     |     |    |    |
| Hare, Captain John ... Lincoln     | 10  | 10 | 0  | of Alford, by Dr. Cookson            | 10  | 0  | 0  |
| Hawling, Mr. T. ... Horncastle     | 5   | 0  | 0  | Manby, Mr. John. Bead's Hall         | 52  | 0  | 0  |
| Hayward, Mr. Ald. W. ... Lincoln   | 5   | 5  | 0  | Mangles, Mrs. ....                   | 50  | 0  | 0  |
| Hayward, Mr. Ald. C. ... Lincoln   | 21  | 0  | 0  | Manners, Right Hon. Lady Robt.       | 21  | 0  | 0  |
| Heneage, Mr. .... Hainton Hall     | 21  | 0  | 0  | Manners, General .... Bloxham        | 10  | 0  | 0  |
| Henson, Mr. Robert ... Bainton     | 10  | 5  | 0  | Manners, Mr George .. Bloxham        | 225 | 0  | 0  |
| Herbert, Rev. Dr. ... Lincoln      | 18  | 16 | 0  | Marris, Mr. T. .... Barton           | 10  | 10 | 0  |
| Hett, Mr. Ald. .... Lincoln        | 10  | 10 | 0  | Massey, Mr. .... Spalding            | 10  | 10 | 0  |
| Hett, Dr. R. Hobart .. Lincoln     | 21  | 0  | 0  | Massingberd, Mr. .... Ormsby         | 50  | 0  | 0  |
| Hickson, Mrs. .... Lincoln         | 5   | 0  | 0  | Massingberd, Rev. F. Washingbro'     | 10  | 10 | 0  |
| Hickson, Miss .... Lincoln         | 5   | 0  | 0  | Massingberd, Mrs, C. ... Lincoln     | 5   | 5  | 0  |
| Hickson, Miss Ann ... Lincoln      | 5   | 0  | 0  | Middleton, Right Rev. Dr.            |     |    |    |
| Hickson, Miss Sarah ... Lincoln    | 5   | 0  | 0  | Bishop of Calcutta ....              | 5   | 0  | 0  |
| Hird, Mr. Samuel .. Nettleham      | 5   | 0  | 0  | Milson, Mrs... .... Lincoln          | 21  | 0  | 0  |
| Horner, Mr. James B. ... Lincoln   | 5   | 0  | 0  | Milnes, Mr. .... Aisthorpe           | 10  | 0  | 0  |
| Hume, Sir Abraham, Bart. ....      | 21  | 0  | 0  | Monson, Lord, .... Burton            | 100 | 0  | 0  |
| Hutton, Mr. .... Gate Burton       | 20  | 0  | 0  | Monson, Dowage Lady E. ....          | 10  | 0  | 0  |
| Hutton, Rev. Dr. .... Sutterton    | 20  | 0  | 0  | Monson, Colonel, the Hon. Wm.        | 30  | 0  | 0  |
| Hutton, Mr. .... Lincoln           | 21  | 0  | 0  | Moody, Mr. Robert ... Lincoln        | 5   | 0  | 0  |
| Illingworth, Rev. Dr. Scampton     | 5   | 5  | 0  | Moore, Mr. G. .... Canwick           | 5   | 0  | 0  |
| Jepson, Mr. Ald. .... Lincoln      | 5   | 5  | 0  | Morgan, Miss .... Grantham           | 10  | 0  | 0  |
| Johnson, Rev. Dr. ... Spalding     | 10  | 10 | 0  | Morgan, Mrs. S. .... Grantham        | 5   | 5  | 0  |
| Kaye, Lady .... Coleby             | 50  | 0  | 0  | Myers, Rev. J. .... Swineshead       | 5   | 5  | 0  |
| Kent, Lady .... Kingston           | 10  | 10 | 0  | Nelthorpe, Mr. John .. Lincoln       | 10  | 10 | 0  |
| Kent, Mr. Alderman ... Lincoln     | 10  | 10 | 0  | Nelthorpe, Lady .... Lincoln         | 10  | 10 | 0  |
| Kent, Mr. Robert ... London        | 10  | 10 | 0  | Newton, Mrs. Houblon ...             | 5   | 0  | 0  |
| Kent, Mr. Thomas Westoby ..        | 20  | 0  | 0  | Orme, Rev. Dr. .... Louth            | 5   | 0  | 0  |
| King, Mr. Clifford. .... Ashby     | 21  | 0  | 0  | Otter, Mr. Francis ... Stainton      | 21  | 0  | 0  |
| King, Mrs. Captain, Tiddenham      | 21  | 0  | 0  | Otter, Mr. Henry ... Wath            | 25  | 0  | 0  |
| Kipling, Dr. the Very Rev. the     |     |    |    | Ditto, penalty from an offender      | 7   | 0  | 0  |
| Dean of Peterborough ...           | 100 | 0  | 0  | Otter, Miss .... Ranby House         | 25  | 0  | 0  |
| Lady unknown ...                   | 50  | 0  | 0  | Overton, Mr. Titus .. Horncastle     | 5   | 5  | 0  |
| Lady unknown, by R. ....           | 10  | 0  | 0  | Parkinson, Mr. R. .... Reppham       | 5   | 5  | 0  |
| Lambe, Mr. .... Auburn             | 5   | 0  | 0  | Parkinson, Rev. Dr. ... Ravendale    | 21  | 0  | 0  |
| Lawrence, Mr. J. ... Grantham      | 5   | 5  | 0  | Parnell, Mr. G. .... Gainsbro'       | 10  | 10 | 0  |
| Lawrence, Miss ...                 | 5   | 5  | 0  | Partridge, Rev, S. .... Boston       | 5   | 5  | 0  |
| Laycock, Rev. Tillotson, Lincoln   | 5   | 2  | 0  | Peacock, Mr. Anthony .. Kyme         | 21  | 0  | 0  |
| Lincoln, Right Rev. George         |     |    |    | Peacock, Mr. T. A. .... Kyme         | 10  | 10 | 0  |
| Tomline, Lord Bishop of ..         | 50  | 0  | 0  | Peacock, and Co. Sleaford, for       |     |    |    |
| Lincoln Cathedral, Senior Vicars   |     |    |    | a Gentleman unknown ....             | 50  | 0  | 0  |
| of, 1807 ...                       | 10  | 10 | 0  | Pelham, Hon. George ...              | 21  | 0  | 0  |

|                                                             | £  | s. | d. |                                                                   | £   | s. | d. |
|-------------------------------------------------------------|----|----|----|-------------------------------------------------------------------|-----|----|----|
| Pell, Mr. Paul . . . . .Tupholme                            | 5  | 0  | 0  | Tennyson, Mr. . . . .Bayon's Manor                                | 21  | 0  | 0  |
| Peterborough, Rt. Rev. Spencer<br>Madan, Lord Bishop of . . | 10 | 10 | 0  | Terrewest, Mr. . . . . .Lincoln                                   | 10  | 0  | 0  |
| Pollock, Mrs. . . . . .Lincoln                              | 5  | 0  | 0  | Tesh, Mr. . . . . .Lincoln                                        | 7   | 7  | 0  |
| Porter, Mr. Alderman. . . . .Lincoln                        | 10 | 10 | 0  | Thirkill, Mr. Francis . . . . .Boston                             | 21  | 0  | 0  |
| Preston, Mr. Alderman. . . . .Lincoln                       | 10 | 10 | 0  | Thirkill, Mr. . . . . .Boston                                     | 21  | 0  | 0  |
| Preston, Mr. Thomas . . . . .Lincoln                        | 21 | 0  | 0  | Thornton, Mr. Samuel . . . . .                                    | 21  | 0  | 0  |
| Proprietors of the late Lincoln<br>Chronicle . . . . .      | 5  | 5  | 0  | Thorpe, Mr. Anthony . . . . .York                                 | 10  | 0  | 0  |
| Rasdall, Mr. J. . . . .Louth                                | 5  | 0  | 0  | Thorold, Mrs. . . . . .Torquay                                    | 10  | 10 | 0  |
| Rawlins, Rev. J. . . . .Carlton                             | 5  | 5  | 0  | Timberland, Mr. T. . . . .Lincoln                                 | 5   | 0  | 0  |
| Reynardson, Mr. J. . . . .Holywell                          | 21 | 0  | 0  | Tunnard, Mr. . . . .Frampton House                                | 21  | 0  | 0  |
| Robertson, Mr. produce of 2 plays                           | 36 | 6  | 6  | Turnell, Mr. Thomas . . . . .Reasby                               | 5   | 5  | 0  |
| Rockliffe, Mrs. . . . . .Horncastle                         | 21 | 0  | 0  | Turner, Mr. . . . . .Caistor                                      | 5   | 5  | 0  |
| Rogerson, Mr. William. . . . .Boston                        | 21 | 0  | 0  | Turner, Rev. S. . . . . .Caistor                                  | 5   | 5  | 0  |
| Ruth, a tribute of gratitude. . . . .                       | 10 | 10 | 0  | Turnor, Mr. Edmund . . . . .Stoke                                 | 100 | 0  | 0  |
| Saunders, Rev. C. . . . .Stamford                           | 5  | 0  | 0  | Turnor, Rev. G. . . . . .Wragby                                   | 10  | 10 | 0  |
| Saunders, Mr. S. . . . .Morton                              | 21 | 0  | 0  | Two Ladies, in aid of the im-<br>provements in progress . . . . . | 5   | 0  | 0  |
| Schuts, Rev. W. Burton Coggles                              | 5  | 5  | 0  | Uppleby, Mr. for a Gentleman<br>unknown . . . . .Wootton          | 40  | 0  | 0  |
| Sedgwick, Mrs. . . . . .Lincoln                             | 50 | 0  | 0  | Wallis, Mr. George . . . . .York                                  | 105 | 0  | 0  |
| Shaw, Mr. Thomas . . . . .Burton                            | 10 | 10 | 0  | Walls, Rev. E. . . . . .Spilsby                                   | 21  | 0  | 0  |
| Shepherd, Rev. Mr. . . . . .                                | 5  | 5  | 0  | Wayett, Rev. Dr. . . . . .Pinchbeck                               | 11  | 11 | 0  |
| Sibthorp, Colonel H. . . . .Canwick                         | 52 | 0  | 0  | Welby, Mr. Earle. . . . .London                                   | 10  | 10 | 0  |
| Sibthorp, Colonel, Coningsby W.                             | 50 | 0  | 0  | Wood, Mrs. . . . . .Bath                                          | 21  | 0  | 0  |
| Slater, Mr. S. . . . .North Carlton                         | 5  | 0  | 0  | Westmoreland, Mr. . . . .Billingbro'                              | 10  | 10 | 0  |
| Smith, Mr. Tyrwhitt . . . . .Lincoln                        | 21 | 0  | 0  | Wetherall, Mr. J. . . . .Gainsbro'                                | 10  | 10 | 0  |
| Smith, Mr. John . . . . .Gainsbro'                          | 20 | 0  | 0  | Whichcote, Sir T. Bt. Aswardby                                    | 100 | 0  | 0  |
| Smith, Mr. Samuel . . . . .London                           | 50 | 0  | 0  | Wilkinson, Mr. . . . . .Kyme                                      | 5   | 5  | 0  |
| Snow, Rev. M. . . . . .                                     | 10 | 10 | 0  | Williams, Mrs. . . . . .Lincoln                                   | 5   | 5  | 0  |
| St. Albans, Her Grace the Duchess<br>of . . . . .Redbourn   | 21 | 0  | 0  | Willis, Dr. . . . . .Gretford                                     | 500 | 0  | 0  |
| Stonehewer, Mr. Richard. . . . .                            | 21 | 0  | 0  | Willis, Rev. Dr. . . . . .Gretford                                | 55  | 0  | 0  |
| Straw, Mr. Alderman . . . . .Lincoln                        | 5  | 5  | 0  | Willis, Dr. John. . . . .Gretford                                 | 20  | 0  | 0  |
| Sutton, Rev. R. . . . .Broughton                            | 10 | 10 | 0  | Wilson, Mrs. . . . . .Lincoln                                     | 10  | 10 | 0  |
| Swan, Mr. Alderman . . . . .Lincoln                         | 21 | 0  | 0  | Wilson, Mr. W. R. . . . .Lincoln                                  | 10  | 10 | 0  |
| Swan, Mr. John . . . . .Ollerton                            | 51 | 0  | 0  | Wilson, Dr. . . . . .Grantham                                     | 10  | 10 | 0  |
| Swan, Mr. Ald. Henry. . . . .Lincoln                        | 5  | 0  | 0  | W. H. . . . . .                                                   | 5   | 5  | 0  |
| Sykes, Mr. Daniel . . . . .Raywell                          | 20 | 0  | 0  | Wollaston, Rev. J. H. . . . .Scotter                              | 10  | 15 | 0  |
| Taylor, Mrs. . . . . .Lincoln                               | 21 | 0  | 0  | Wray, Lady . . . . .Summer Castle                                 | 55  | 0  | 0  |
| Taylor, Rev. Mr. . . . . .Spridlington                      | 8  | 8  | 0  | Yarborough, Right Hon. Lord. . . . .                              | 100 | 0  | 0  |

## LEGACIES.

|                                                                    | £   | s. | d. |                                                                     | £   | s. | d. |
|--------------------------------------------------------------------|-----|----|----|---------------------------------------------------------------------|-----|----|----|
| Benet, Mrs. Ann . . . . .Lincoln                                   | 50  | 0  | 0  | Savage, Mr. Pool . . . . .Lincoln,<br>by Mr. Joseph Moore . . . . . | 90  | 0  | 0  |
| Cartwright, Mr. . . . . .Ingham                                    | 90  | 0  | 0  | Shaw, Mr. Thomas Burton . . . . .                                   | 450 | 0  | 0  |
| Coltman, Mr. T. . . . .Hagnaby                                     | 449 | 8  | 3  | Simpson, Mr. . . . . .Ingleby                                       | 10  | 0  | 0  |
| Gildart, Rev. F. Rector of Sprid-<br>lington, by Rev. H. F. Hutton | 250 | 0  | 0  | Smith, Miss Ann, Bath, by Miss<br>Mary Mossop . . . . .Langtoft     | 49  | 0  | 0  |
| King, Mr. Clifford, Ashby-de-la-<br>Laund, by the Rev. J. King     | 50  | 0  | 0  | Thorold, Sir J. Bart. . . . .Syston                                 | 90  | 0  | 0  |
| Maltby, Mr. W. . . . . .Coates,<br>by Mr. Skill . . . . .          | 450 | 0  | 0  | Westland, Mr. John. . . . .Boston,<br>by Mr. S. Veal. . . . .       | 101 | 6  | 8  |
| Massingberd, Mrs. . . . . .Lincoln                                 | 50  | 0  | 0  | Williams, Mrs. . . . . .Lincoln                                     | 10  | 0  | 0  |
| Oxspring, Mr. John. . . . .Lincoln                                 | 450 | 0  | 0  | Wilson, Mr. R. . . . .Willingham<br>by Stow . . . . .               | 10  | 0  | 0  |
| Parnell, Mr. Paul . . . . .Lincoln                                 | 100 | 0  | 0  | Wilson, Mr. Robert, Nettleham,<br>by Mr. J. L. Fytche . . . . .     | 100 | 0  | 0  |
| Reeve, Mrs. . . . . .Leadenham                                     | 45  | 0  | 0  |                                                                     |     |    |    |

Benefactions under Five Pounds . . . . .£ 199 2 6  
Parochial Collections . . . . . 1911 8 1

STATE OF THE PATIENTS.



*Number of the Patients admitted, and of those discharged from the Books,*

| From Jan. 1, 1842, to Dec. 31, 1842. |    |    |      | From April 26, 1820, to Dec. 31, 1842. |     |     |      |
|--------------------------------------|----|----|------|----------------------------------------|-----|-----|------|
|                                      | M. | F. | Tot. |                                        | M.  | F.  | Tot. |
| Remained Jan. 1, 1842                | 50 | 42 | 92   |                                        |     |     |      |
| Admitted in 1842                     | 32 | 29 | 61   | Admitted                               | 417 | 343 | 760  |
| Re-admitted in 1842                  | 9  | 9  | 18   | Re-admitted                            | 91  | 86  | 177  |
| Discharged in 1842                   | 29 | 30 | 59   | Discharged                             | 446 | 379 | 825  |
| Remained Dec. 31, 1842               | 62 | 50 | 112  | Remained Dec. 31, 1842                 | 62  | 50  | 112  |

*State of the Patients when discharged from the Books,*

| From Jan 1, 1842, to Dec. 31, 1842. |           | From April 26, 1820, to Dec. 31, 1842. |            |
|-------------------------------------|-----------|----------------------------------------|------------|
| Recovered                           | 15        | Recovered                              | 352        |
| Improved                            | 4         | Improved                               | 82         |
| Removed during treatment            | 21        | Removed during treatment               | 183        |
| Improper objects                    | 0         | Improper objects                       | 2          |
| By order of the Board               | 2         | By order of the Board                  | 23         |
| Escaped                             | 0         | Escaped                                | 7          |
| Dead                                | 17        | Dead                                   | 176        |
|                                     | <u>59</u> |                                        | <u>825</u> |

*Re-admissions.*

| <i>Of the 760 Patients admitted, have been Re-admitted,</i> | <i>Of the 352 Patients discharged as recovered, have been Re-admitted,</i> |
|-------------------------------------------------------------|----------------------------------------------------------------------------|
| 92 Patients 1 time each..... 92 cases                       | 40 Patients 1 time each..... 40 cases                                      |
| 16 ..... 2 times each..... 32                               | 15 ..... 2 times each..... 30                                              |
| 5 ..... 3 ..... 15                                          | 3 ..... 3 ..... 9                                                          |
| 3 ..... 5 ..... 15                                          | 3 ..... 5 ..... 15                                                         |
| 1 ..... 7 ..... 7                                           | 1 ..... 7 ..... 7                                                          |
| 2 ..... 8 ..... 16                                          | 2 ..... 8 ..... 16                                                         |
| <u>119 Patients..... 177 cases.</u>                         | <u>64 Patients..... 117 cases.</u>                                         |

Of whom 10 have died and 5 remain in the Asylum.

|                                                | 1820 | 1821 | 1822 | 1823 | 1824 | 1825 | 1826 | 1827 | 1828 | 1829 | 1830 | 1831 | 1832 | 1833 | 1834 | 1835 | 1836 | 1837 | 1838 | 1839  | 1840  | 1841 | 1842. | Totals. |
|------------------------------------------------|------|------|------|------|------|------|------|------|------|------|------|------|------|------|------|------|------|------|------|-------|-------|------|-------|---------|
| Carried on to each year                        | ..   | 13   | 15   | 21   | 27   | 30   | 34   | 44   | 45   | 42   | 49   | 41   | 44   | 47   | 50   | 66   | 62   | 85   | 88   | 101   | 109   | 96   | 92    |         |
| Admitted in ditto.....                         | 21   | 21   | 20   | 23   | 32   | 25   | 31   | 23   | 37   | 35   | 33   | 20   | 30   | 34   | 40   | 32   | 43   | 33   | 57   | 45    | 27    | 37   | 61    | 760     |
| Re-admitted in ditto ...                       | ..   | 2    | ..   | 2    | ..   | 7    | 4    | 4    | 4    | 6    | 10   | 9    | 7    | 6    | 19   | 10   | 10   | 12   | 13   | 13    | 6     | 15   | 18    | 177     |
| Total under care in ditto                      | 21   | 36   | 35   | 46   | 59   | 62   | 69   | 71   | 86   | 83   | 92   | 70   | 81   | 87   | 109  | 108  | 115  | 130  | 158  | 159   | 142   | 148  | 171   |         |
| Daily Average in ditto..                       | 6.8  | 15.  | 16.7 | 21.6 | 31.  | 33.4 | 40.8 | 44.3 | 47.  | 41.7 | 49.7 | 43.6 | 49.  | 51.5 | 56.3 | 61.2 | 76.5 | 90.  | 94.5 | 107.2 | 104.2 | 97.2 | 101.  | 56.     |
| Recovered in ditto ....                        | 6    | 7    | 8    | 12   | 10   | 13   | 14   | 12   | 19   | 15   | 31   | 13   | 12   | 11   | 16   | 17   | 23   | 15   | 31   | 25    | 10    | 17   | 15    | 352     |
| Otherwise removed in do                        | 2    | 11   | 4    | 3    | 14   | 8    | 8    | 8    | 18   | 18   | 12   | 4    | 10   | 17   | 23   | 20   | 3    | 12   | 16   | 15    | 20    | 24   | 27    | 297     |
| Died in ditto .....                            | ..   | 3    | 2    | 4    | 5    | 7    | 3    | 6    | 7    | 1    | 8    | 9    | 12   | 9    | 4    | 9    | 4    | 15   | 10   | 10    | 16    | 15   | 17    | 176     |
| Remained from ditto, }<br>December 31, 1842. } | ..   | ..   | ..   | 1    | 2    | ..   | 1    | 2    | ..   | ..   | ..   | 1    | 2    | 3    | 2    | 3    | 9    | 2    | 9    | 12    | 6     | 16   | 41    | 112     |
| <b>CAUSES OF THE DEATHS.</b>                   |      |      |      |      |      |      |      |      |      |      |      |      |      |      |      |      |      |      |      |       |       |      |       |         |
| Apoplexy .....                                 | ..   | 1    | 1    | ..   | ..   | 1    | ..   | ..   | ..   | ..   | ..   | ..   | ..   | 1    | ..   | 1    | 1    | ..   | 2    | 2     | 2     | 1    | ..    | 13      |
| Catalepsy .....                                | ..   | ..   | ..   | ..   | 1    | ..   | ..   | ..   | ..   | ..   | ..   | ..   | ..   | ..   | ..   | ..   | ..   | ..   | ..   | ..    | ..    | ..   | ..    | 1       |
| Cholera Morbus .....                           | ..   | ..   | ..   | ..   | ..   | ..   | ..   | ..   | ..   | ..   | ..   | ..   | ..   | ..   | ..   | ..   | ..   | ..   | ..   | 1     | ..    | ..   | ..    | 1       |
| Consumption .....                              | ..   | ..   | ..   | ..   | ..   | ..   | ..   | ..   | ..   | ..   | ..   | ..   | 3    | ..   | ..   | ..   | ..   | 4    | 1    | 1     | 1     | 5    | ..    | 17      |
| Diarrhoea .....                                | ..   | ..   | ..   | ..   | ..   | ..   | ..   | ..   | ..   | ..   | ..   | ..   | 1    | ..   | ..   | ..   | ..   | ..   | 1    | ..    | ..    | 1    | ..    | 5       |
| Disease of Bowels .....                        | ..   | ..   | ..   | ..   | ..   | ..   | ..   | ..   | ..   | ..   | ..   | ..   | ..   | ..   | ..   | 1    | ..   | ..   | ..   | ..    | ..    | ..   | ..    | 5       |
| Brain .....                                    | ..   | ..   | ..   | ..   | ..   | ..   | ..   | ..   | ..   | ..   | ..   | ..   | ..   | ..   | ..   | ..   | ..   | ..   | ..   | ..    | ..    | ..   | ..    | 9       |
| Heart .....                                    | ..   | ..   | ..   | ..   | ..   | ..   | ..   | ..   | ..   | ..   | ..   | ..   | ..   | ..   | ..   | ..   | ..   | ..   | ..   | ..    | ..    | ..   | ..    | 2       |
| Liver .....                                    | ..   | ..   | ..   | ..   | ..   | ..   | ..   | ..   | ..   | ..   | ..   | ..   | ..   | ..   | ..   | ..   | ..   | ..   | ..   | ..    | ..    | ..   | ..    | 2       |
| Dropsy .....                                   | ..   | ..   | ..   | ..   | ..   | 1    | 2    | ..   | ..   | ..   | ..   | ..   | ..   | ..   | ..   | ..   | ..   | ..   | ..   | ..    | ..    | ..   | ..    | 1       |
| Dying when admitted ..                         | ..   | ..   | ..   | ..   | ..   | 1    | ..   | 1    | 1    | ..   | ..   | ..   | ..   | ..   | ..   | ..   | ..   | ..   | ..   | ..    | ..    | ..   | ..    | 7       |
| Erysipelas .....                               | ..   | ..   | ..   | ..   | ..   | ..   | ..   | ..   | ..   | ..   | ..   | ..   | ..   | ..   | ..   | ..   | ..   | ..   | ..   | ..    | ..    | ..   | ..    | 1       |
| Epilepsy .....                                 | ..   | ..   | ..   | ..   | ..   | ..   | ..   | 1    | 1    | ..   | 1    | 2    | 1    | ..   | ..   | ..   | ..   | 1    | 1    | 1     | 1     | ..   | ..    | 11      |
| Fever .....                                    | ..   | ..   | ..   | ..   | ..   | ..   | ..   | 1    | 1    | ..   | ..   | 1    | ..   | 1    | ..   | ..   | ..   | 3    | ..   | 1     | 2     | ..   | ..    | 9       |
| Found dead in bed .....                        | ..   | ..   | ..   | ..   | ..   | ..   | ..   | ..   | ..   | ..   | ..   | ..   | ..   | ..   | ..   | ..   | ..   | ..   | ..   | ..    | ..    | ..   | ..    | 2       |
| Gradual Exhaustion ..                          | ..   | 1    | ..   | ..   | ..   | 2    | 1    | 2    | 2    | ..   | 6    | 5    | 1    | 3    | ..   | 1    | 1    | 1    | 2    | ..    | 5     | 5    | 4     | 42      |
| Inflamed Brain .....                           | ..   | ..   | ..   | ..   | ..   | ..   | ..   | ..   | ..   | ..   | ..   | ..   | ..   | ..   | ..   | ..   | ..   | ..   | ..   | ..    | ..    | ..   | ..    | 2       |
| Lungs .....                                    | ..   | ..   | ..   | ..   | ..   | ..   | ..   | ..   | ..   | ..   | ..   | ..   | ..   | ..   | ..   | 2    | ..   | ..   | ..   | ..    | ..    | ..   | ..    | 2       |
| Parotid Gland .....                            | ..   | ..   | ..   | ..   | ..   | ..   | ..   | ..   | ..   | ..   | ..   | ..   | ..   | ..   | ..   | 1    | ..   | ..   | ..   | ..    | ..    | ..   | ..    | 2       |
| Trachea .....                                  | ..   | ..   | ..   | ..   | ..   | ..   | ..   | ..   | ..   | ..   | ..   | ..   | ..   | ..   | ..   | ..   | ..   | ..   | ..   | ..    | ..    | ..   | ..    | 1       |
| Locked Jaw .....                               | ..   | ..   | ..   | ..   | ..   | 1    | ..   | ..   | ..   | ..   | ..   | ..   | ..   | ..   | ..   | ..   | ..   | ..   | ..   | ..    | ..    | ..   | ..    | 1       |
| Maniacal Exhaustion ..                         | ..   | ..   | ..   | ..   | ..   | ..   | ..   | ..   | 1    | 1    | ..   | ..   | 2    | 1    | ..   | 1    | ..   | ..   | ..   | ..    | ..    | ..   | ..    | 6       |
| Old Age .....                                  | ..   | ..   | ..   | ..   | ..   | ..   | ..   | 1    | 1    | ..   | ..   | ..   | ..   | ..   | ..   | ..   | ..   | ..   | ..   | ..    | ..    | ..   | ..    | 8       |
| Paralysis .....                                | ..   | ..   | ..   | ..   | ..   | ..   | ..   | ..   | ..   | ..   | 1    | ..   | ..   | ..   | ..   | ..   | ..   | ..   | ..   | ..    | ..    | ..   | ..    | 4       |
| Psoas Abscess .....                            | ..   | ..   | ..   | ..   | ..   | 1    | ..   | ..   | ..   | ..   | ..   | 1    | ..   | 1    | ..   | ..   | ..   | ..   | ..   | 1     | ..    | ..   | ..    | 4       |
| Suicide .....                                  | ..   | 1    | ..   | ..   | 1    | ..   | ..   | ..   | ..   | ..   | ..   | 1    | ..   | 1    | 2    | 1    | ..   | ..   | ..   | 1     | ..    | ..   | ..    | 7       |
| Tabes .....                                    | ..   | ..   | ..   | ..   | ..   | ..   | ..   | ..   | ..   | ..   | ..   | ..   | 4    | 1    | ..   | ..   | ..   | ..   | ..   | ..    | ..    | ..   | ..    | 5       |
| Tumor of the Uterus ...                        | ..   | ..   | ..   | ..   | ..   | ..   | ..   | ..   | ..   | ..   | ..   | ..   | ..   | ..   | ..   | ..   | ..   | ..   | ..   | ..    | ..    | ..   | ..    | 1       |
| Water in the Head .....                        | ..   | ..   | ..   | ..   | ..   | ..   | ..   | ..   | ..   | ..   | ..   | ..   | ..   | ..   | ..   | 1    | ..   | ..   | ..   | ..    | ..    | ..   | ..    | 1       |

From 1820 to 1826 inclusive, each year commences with April 1, and afterwards with January 1; leaving 9 months only for 1827.



*Periods of Decease after Admission in 1842.*

| Between<br>1—7 days | Days<br>7—14 | Weeks<br>2—4 | Months<br>1—3 | Months<br>3—6 | Months<br>6—12 | Years<br>1—2 | Years<br>2—3 | Years<br>3—18 | Total. |
|---------------------|--------------|--------------|---------------|---------------|----------------|--------------|--------------|---------------|--------|
| 1                   | 2            | 1            | 2             | 2             | 1              | 0            | 2            | 6             | 17     |

*Periods of Decease after Admission, from the commencement of the Institution.*

| Between<br>1—7 days | Days<br>7—14 | Weeks<br>2—4 | Months<br>1—3 | Months<br>3—6 | Months<br>6—12 | Years<br>1—2 | Years<br>2—3 | Years<br>3—18 | Total. |
|---------------------|--------------|--------------|---------------|---------------|----------------|--------------|--------------|---------------|--------|
| 7                   | 11           | 10           | 20            | 20            | 27             | 26           | 16           | 39            | 176    |

*Ages at the time of Decease in 1842.*

| Betw. 20 | 20—30 | 30—40 | 40—50 | 50—60 | 60—70 | 70 & upw. | unknown | Total. |
|----------|-------|-------|-------|-------|-------|-----------|---------|--------|
| 0        | 5     | 3     | 4     | 2     | 2     | 1         | 0       | 17     |

*Ages at the time of Decease, from the commencement of the Institution.*

| Betw. 20 | 20—30 | 30—40 | 40—50 | 50—60 | 60—70 | 0 & upw. | unknown | Total. |
|----------|-------|-------|-------|-------|-------|----------|---------|--------|
| 1        | 20    | 39    | 36    | 31    | 26    | 14       | 9       | 176    |

*Number of Deaths in each month, from the commencement of the Institution.*

| Jan. | Feb. | Mar. | April | May | June | July | Aug. | Sep. | Oct. | Nov. | Dec. | Total |
|------|------|------|-------|-----|------|------|------|------|------|------|------|-------|
| 13   | 14   | 10   | 19    | 16  | 19   | 13   | 18   | 7    | 16   | 16   | 15   | 176   |

WEEKLY RETURN  
OF THE STATE OF THE PATIENTS,  
from 8 a. m. Jan. 9, to 8 a. m. Jan. 16, 1843.

|                                                      | M. | F. | Totals. |
|------------------------------------------------------|----|----|---------|
| <i>Number of Patients in the House.</i>              | 61 | 50 | 111     |
| <i>First Rank.</i>                                   | 2  | 3  | 5       |
| <i>Second Rank.</i>                                  | 3  | 5  | 8       |
| <i>Third Rank.</i>                                   | 56 | 42 | 98      |
| <i>Maintained by their Friends.</i>                  | 13 | 16 | 29      |
| <i>Maintained by the Public.</i>                     | 48 | 34 | 82      |
| <i>Less than 1 year since the 1st attack.</i>        | 2  | 3  | 5       |
| <i>From 1 to 2 years since the 1st attack.</i>       | 3  | 4  | 7       |
| <i>More than 2 years since the 1st attack.</i>       | 56 | 43 | 99      |
| <i>Less than 1 year since admission.</i>             | 14 | 15 | 29      |
| <i>From 1 to 2 years since admission.</i>            | 9  | 5  | 14      |
| <i>From 2 to 18 years since admission.</i>           | 21 | 20 | 41      |
| <i>Re-admitted cases, not included in the above.</i> | 17 | 10 | 27      |
| <i>Not expected to recover.</i>                      | 49 | 35 | 84      |
| <i>Expected to recover.</i>                          | 12 | 14 | 26      |
| <i>Convalescent.</i>                                 | 0  | 1  | 1       |
| <i>Cases of Idiocy.</i>                              | 5  | 1  | 6       |
| <i>Cases of Epilepsy.</i>                            | 6  | 4  | 10      |
| <i>Cases of Paralysis.</i>                           | 0  | 1  | 1       |
| <i>Cases of Imbecility.</i>                          | 37 | 25 | 62      |
| <i>Having attempted Suicide.</i>                     | 11 | 12 | 23      |
|                                                      |    |    |         |
|                                                      |    |    |         |

DAILY RETURN OF THE STATE OF THE PATIENTS,

from 8 a. m. Jan. 9, to 8 a. m. Jan. 16, 1843.

| NUMBER OF PATIENTS.                    | MALE. |    |    |     |    |    |     | FEMALE. |    |    |     |    |    |     |
|----------------------------------------|-------|----|----|-----|----|----|-----|---------|----|----|-----|----|----|-----|
|                                        | M.    | T. | W. | TH. | F. | S. | SU. | M.      | T. | W. | TH. | F. | S. | SU. |
| In the orderly wards . . . . .         | 34    | 34 | 34 | 35  | 35 | 35 | 36  | 22      | 20 | 23 | 23  | 22 | 23 | 25  |
| In the disorderly wards . . . . .      | 29    | 29 | 29 | 28  | 28 | 26 | 25  | 28      | 30 | 27 | 27  | 28 | 27 | 25  |
| With confined bowels . . . . .         | 1     | .. | .. | 3   | 1  | 2  | 2   | 1       | 1  | .. | 1   | .. | .. | ..  |
| With relaxed bowels . . . . .          | 1     | .. | .. | ..  | .. | .. | ..  | ..      | .. | .. | ..  | .. | 1  | 1   |
| Uncleanly by day . . . . .             | 1     | .. | .. | 1   | .. | .. | 1   | ..      | .. | .. | 1   | .. | .. | ..  |
| Uncleanly by night . . . . .           | 1     | 2  | 2  | ..  | 1  | .. | 1   | ..      | 1  | 1  | 1   | 1  | .. | 2   |
| Wet by day . . . . .                   | 1     | 1  | 1  | ..  | 2  | 1  | 1   | 3       | 3  | 2  | 3   | 1  | 2  | 2   |
| Wet by night . . . . .                 | 3     | 3  | 3  | 10  | 5  | 7  | 9   | 4       | 4  | 7  | 8   | 8  | 9  | 3   |
| Noisy in the night . . . . .           | ..    | 1  | 1  | ..  | .. | 1  | ..  | 5       | 5  | 2  | 3   | 3  | 3  | 3   |
| Having destroyed their clothing. . .   | ..    | .. | .. | ..  | .. | 3  | ..  | ..      | 1  | 1  | 2   | 1  | 1  | 1   |
| Having destroyed their bedding. . .    | 1     | .. | .. | ..  | .. | .. | ..  | ..      | .. | .. | ..  | 1  | .. | ..  |
| Having refused a part of their food    | 5     | 4  | 4  | 4   | 5  | 4  | 4   | ..      | .. | .. | ..  | 1  | .. | 2   |
| Having refused whole of their food     | 1     | .. | 1  | ..  | .. | .. | ..  | ..      | .. | .. | ..  | .. | .. | ..  |
| Having attempted suicide . . . . .     | ..    | .. | .. | ..  | .. | .. | ..  | ..      | .. | .. | ..  | .. | .. | ..  |
| Under medicinal treatment . . . . .    | 2     | 1  | 1  | ..  | .. | 1  | 1   | ..      | .. | .. | ..  | .. | .. | ..  |
| Under surgical treatment . . . . .     | 1     | .. | 1  | ..  | .. | .. | ..  | 1       | 1  | 1  | 1   | 1  | 1  | 1   |
| Under hired nursing . . . . .          | ..    | .. | .. | ..  | .. | .. | ..  | ..      | .. | .. | ..  | .. | .. | ..  |
| Under night watching . . . . .         | 24    | 24 | 24 | 24  | 24 | 24 | 24  | 24      | 24 | 24 | 24  | 24 | 24 | 23  |
| Keeping their beds by day . . . . .    | 2     | 2  | 2  | 2   | .. | 2  | 2   | 1       | 1  | 1  | 1   | 1  | 1  | 2   |
| Allowed wine . . . . .                 | ..    | .. | .. | ..  | .. | .. | ..  | ..      | .. | .. | ..  | .. | .. | ..  |
| Allowed malt liquor . . . . .          | ..    | .. | .. | ..  | .. | .. | ..  | ..      | .. | .. | ..  | .. | .. | ..  |
| Allowed extra meat . . . . .           | 1     | 1  | 1  | 1   | .. | .. | ..  | 1       | 1  | 1  | 1   | 1  | 1  | 1   |
| Disallowed meat . . . . .              | 3     | 3  | 3  | 3   | 3  | 3  | ..  | ..      | .. | .. | ..  | .. | .. | ..  |
| Forcibly fed . . . . .                 | ..    | .. | .. | ..  | .. | .. | ..  | ..      | .. | .. | ..  | .. | .. | ..  |
| Engaged in active employment . . .     | 28    | 30 | 30 | 30  | 30 | 29 | 25  | 11      | 8  | 11 | 9   | 8  | 7  | 8   |
| Engaged in sedentary employment        | 1     | .. | .. | ..  | .. | .. | ..  | 12      | 16 | 13 | 13  | 11 | 9  | ..  |
| Incapable of regular occupation . . .  | 26    | 27 | 27 | 28  | 28 | 28 | 26  | 17      | 17 | 17 | 17  | 17 | 17 | 17  |
| Exercised in the front grounds . . . . | 13    | 30 | 30 | 14  | 10 | 35 | 34  | 4       | .. | 7  | 2   | .. | 3  | 10  |
| Exercised in the courts . . . . .      | 27    | 24 | 24 | ..  | .. | 26 | 23  | ..      | .. | 6  | ..  | .. | 4  | 2   |
| Exercised beyond the walls . . . . .   | 1     | 1  | 1  | 1   | 2  | 1  | ..  | ..      | 1  | .. | 1   | .. | .. | ..  |
| Attended evening prayers . . . . .     | 61    | 61 | .. | 61  | 59 | 59 | 59  | 36      | 36 | .. | 34  | 32 | 33 | 35  |

*Recoveries in the Lincoln Lunatic Asylum from the commencement, as affected by the Duration of the Complaint before Admission, or Re-admission.*

| Periods of recovery.                        | Admitted within 3 months of the 1st attack. | Admitted between 3 & 12 mo. of the 1st attack. | Admitted between 1 & 2 years of the 1st attack. | Admitted, the period of attack being upwards of 2 years. | Admitted, having had previous attacks. | Admitted, the period of attack not known. | Admitted, Idiots. | Totals. |
|---------------------------------------------|---------------------------------------------|------------------------------------------------|-------------------------------------------------|----------------------------------------------------------|----------------------------------------|-------------------------------------------|-------------------|---------|
|                                             | 224                                         | 145                                            | 53                                              | 159                                                      | 310                                    | 38                                        | 8                 | 937     |
| Discharged within 3 months after admission. | 80                                          | 16                                             | 3                                               | 3                                                        | 62                                     | 0                                         | 0                 | 164     |
| — between 3 and 6 months after admission.   | 42                                          | 9                                              | 3                                               | 4                                                        | 43                                     | 0                                         | 0                 | 101     |
| — between 6 and 12 months after admission.  | 14                                          | 6                                              | 4                                               | 4                                                        | 30                                     | 0                                         | 0                 | 58      |
| — between 1 and 2 years after admission.    | 2                                           | 5                                              | 0                                               | 1                                                        | 6                                      | 0                                         | 0                 | 14      |
| — between 2 and 3 years after admission.    | 1                                           | 3                                              | 0                                               | 0                                                        | 1                                      | 0                                         | 0                 | 5       |
| — after 3 years.                            | 1                                           | 0                                              | 2                                               | 3                                                        | 4                                      | 0                                         | 0                 | 10      |
| Totals.                                     | 140                                         | 39                                             | 12                                              | 15                                                       | 146                                    | 0                                         | 0                 | 352     |

*Results of the Cases placed on the Books in 1842, as found on March 31st, 1843, following,  
shewing the current Practice of the House.*

| Duration of Attack previous to Admission.                | State when Admitted. |                          |                       | State when discharged from the Books. |                           |       | Remained March 31, 1843. |                          |
|----------------------------------------------------------|----------------------|--------------------------|-----------------------|---------------------------------------|---------------------------|-------|--------------------------|--------------------------|
|                                                          | Expected to Recover. | Not Expected to Recover. | Not Expected to Live. | Recovered.                            | Removed during Treatment. | Dead. | Expected to Recover.     | Not Expected to Recover. |
| Admitted within 3 Months after the 1st Attack.           | 11                   | 3                        | 1                     | 4                                     | 6                         | 2     | 1                        | 2                        |
| Admitted between 3 and 12 Months after the 1st Attack.   | 8                    | 2                        | 0                     | 5                                     | 3                         | 0     | 1                        | 1                        |
| Admitted between 1 and 2 years after the 1st Attack.     | 1                    | 0                        | 0                     | 0                                     | 1                         | 0     | 0                        | 0                        |
| Admitted, the period of Attack being upwards of 2 years. | 5                    | 18                       | 2                     | 3                                     | 5                         | 5     | 0                        | 11                       |
| Admitted, having had previous Attacks.                   | 17                   | 10                       | 1                     | 8                                     | 8                         | 2     | 5                        | 6                        |
| Totals.                                                  | 42                   | 33                       | 4                     | 20                                    | 23                        | 9     | 7                        | 20                       |



## RECEIPTS,

*From January 1st, 1841, to December 31st, 1842.*

---

|                                                                      | £     | s. | d. |
|----------------------------------------------------------------------|-------|----|----|
| Cash from Patients, including payments in advance and for Clothing,  | 3559  | 19 | 11 |
| Annual Subscriptions .....                                           | 99    | 1  | 0  |
| Benefactions.....                                                    | 74    | 1  | 0  |
| By sale of Ashes.....                                                | 1     | 14 | 0  |
| ———— Bones .....                                                     | 2     | 18 | 4½ |
| ———— Grease.....                                                     | 4     | 4  | 11 |
| ———— Rags .....                                                      | 1     | 18 | 1½ |
| ———— Refuse Straw.....                                               | 3     | 5  | 9  |
| ———— Swill.....                                                      | 3     | 0  | 0  |
| ———— Grass from the Lawn.....                                        | 1     | 0  | 0  |
| ———— Building Materials .....                                        | 21    | 18 | 6  |
| Found in the Charity Box.....                                        | 12    | 4  | 6  |
| By the late House Surgeon, repayment of advance for current expenses | 20    | 0  | 0  |
| Balance .....                                                        | 775   | 15 | 6½ |
|                                                                      | £4581 | 1  | 7½ |

---

*STATE OF DEBTS AND CREDITS,*

*January 1st, 1843.*

---

## DEBTS.

|                                  | £    | s. | d. |
|----------------------------------|------|----|----|
| Patients' Advances in hand ..... | 393  | 9  | 5  |
| Due to the Bank.....             | 2775 | 15 | 7  |

## CREDITS.

|                                           |    |   |    |
|-------------------------------------------|----|---|----|
| Due from Patients.....                    | 13 | 4 | 11 |
| Advanced to the Matron in 1831, 1832..... | 30 | 0 | 0  |
| Cash in the hands of the Secretary.....   | 0  | 0 | 0½ |

COMPARATIVE STATEMENT

of the Number and Payments of the Patients, in each of the three last years.

*Number of Patients admitted,*

|                     | 1840, |  | 1841, |  | 1842. |
|---------------------|-------|--|-------|--|-------|
| Self-supported..... | 22    |  | 24    |  | 35    |
| Parochial.....      | 11    |  | 28    |  | 44    |
|                     | <hr/> |  | <hr/> |  | <hr/> |
|                     | 33    |  | 52    |  | 79    |
|                     | <hr/> |  | <hr/> |  | <hr/> |

*Payments of Patients on the books,*

|                | 1840,       |  | 1841,       |  | 1842.        |
|----------------|-------------|--|-------------|--|--------------|
| Self-supported | £1170 16 6½ |  | £1031 19 8½ |  | £1099 12 11½ |
| Parochial....  | £1686 14 0  |  | £1568 1 6½  |  | £1750 13 7   |
|                | <hr/>       |  | <hr/>       |  | <hr/>        |
|                | £2857 10 6½ |  | £2600 1 3   |  | £2850 6 6½   |
|                | <hr/>       |  | <hr/>       |  | <hr/>        |

*Number of each Rank of Patients admitted,*

|                | 1840,       |  | 1841,       |  | 1842,       |
|----------------|-------------|--|-------------|--|-------------|
| First Rank.... | 3 M. 2 F.   |  | 0 M. 1 F.   |  | 3 M. 2 F.   |
| Second Rank..  | 4 .. 5 ..   |  | 7 .. 3 ..   |  | 8 .. 4 ..   |
| Third Rank.... | 7 .. 12 ..  |  | 25 .. 16 .. |  | 30 .. 32 .. |
|                | <hr/>       |  | <hr/>       |  | <hr/>       |
|                | 14 .. 17 .. |  | 32 .. 20 .. |  | 41 .. 38 .. |
|                | <hr/>       |  | <hr/>       |  | <hr/>       |

*Payments of each Rank of Patients on the books,*

|                | 1840,      |  | 1841,         |  | 1842,          |
|----------------|------------|--|---------------|--|----------------|
| First Rank.... | £445 16 0  |  | .. £240 15 0  |  | .. £289 10 0   |
| Second Rank..  | £299 11 11 |  | .. £311 10 8  |  | .. £282 0 9    |
| Third Rank.... | £2112 2 7  |  | .. £2047 15 7 |  | .. £2278 15 9½ |
|                | <hr/>      |  | <hr/>         |  | <hr/>          |
|                | £2857 10 6 |  | £2600 1 3     |  | £2850 6 6½     |
|                | <hr/>      |  | <hr/>         |  | <hr/>          |

*Payments of each Rank of Patients, admitted or re-admitted, from the Opening of the Institution in March, 1820, to December 31st, 1842.*

FIRST RANK.

9 Patients at from £2 12 6 to £1 5 0 per week, £317 6 7  
 77.....at..... £1 1 0..... £5041 1 1.... £5358 7 8

SECOND RANK.

134.....at..... £0 15 0..... £3835 16 5.... £3835 16 5

THIRD RANK.

717.....at from £0 12 0 to £0 8 0..... £25,659 5 8½..£25,659 5 8½  

---

 937  

---

 £34,853 9 9½

Variations in the rates of payment by some of the same Patients, will account for the apparent excess of Patients in the above Table, beyond the real number.



## COMPARATIVE STATEMENT

of the principal Articles Consumed, and the average number of Persons maintained, in each of the three last years.

*Principal Provisions, &c., consumed,*

|                | 1840,  |     |      | 1841,  |     |       | 1842.  |     |       |
|----------------|--------|-----|------|--------|-----|-------|--------|-----|-------|
|                | £      | s.  | d.   | £      | s.  | d.    | £      | s.  | d.    |
| Bread... lbs.  | 52,858 | 386 | 0 0  | 44,658 | 284 | 11 5  | 41,575 | 264 | 19 7  |
| Butter....lbs. | 1,511  | 75  | 4 8  | 1,412  | 79  | 18 5  | 1,548  | 80  | 1 6   |
| Candles...lbs. | 717    | 21  | 10 7 | 728    | 20  | 7 10  | 785    | 22  | 12 11 |
| Cheese....lbs. | 974    | 29  | 5 11 | 372    | 10  | 12 7  | 230    | 6   | 11 10 |
| Coal....tons.  | 233    | 187 | 2 11 | 211    | 165 | 9 7   | 239    | 169 | 12 9  |
| Coffee....lbs. | 167    | 16  | 13 4 | 166    | 16  | 12 0  | 143    | 13  | 0 1   |
| Flour.....sts. | 187    | 26  | 8 7  | 258    | 31  | 15 2  | 292    | 38  | 6 4   |
| Meat....lbs.   | 24,290 | 599 | 5 10 | 21,516 | 546 | 9 6   | 22,072 | 517 | 17 2  |
| Milk....galls. | 6,710  | 195 | 12 6 | 6,535  | 204 | 1 9   | 5,109  | 159 | 14 2  |
| Oatmeal lbs.   | 292    | 2   | 11 6 | 249    | 2   | 6 5   | 229    | 2   | 1 1   |
| Oil.....galls. | 44     | 7   | 8 9  | 17     | 3   | 9 0   | 30     | 6   | 14 6  |
| Potatoes pks.  | 1,650  | 43  | 10 8 | 1,733  | 52  | 17 6  | 2,072  | 52  | 13 5  |
| Rice.....lbs.  | 361    | 4   | 0 6  | 370    | 4   | 15 8  | 389    | 6   | 4 0   |
| Soap.....lbs.  | 1,428  | 34  | 3 0  | 1,442  | 33  | 14 11 | 1,757  | 40  | 5 3   |
| Straw .....    |        | 21  | 6 9  |        | 13  | 0 0   |        | 16  | 11 6  |
| Sugar....lbs.  | 2,011  | 62  | 0 11 | 2,030  | 64  | 13 11 | 2,338  | 70  | 0 1   |
| Tea.....lbs.   | 315    | 83  | 2 7  | 316    | 84  | 14 6  | 314    | 78  | 17 1  |
| Vegetables ..  |        | 17  | 4 9  |        | 11  | 4 4   |        | 14  | 9 3   |

*Daily average number of Persons maintained,*

|                 | 1840,      | 1841,      | 1842.      |
|-----------------|------------|------------|------------|
| Patients .....  | 104        | 97         | 101        |
| Household ..... | 23         | 20         | 19         |
| Totals .....    | <u>127</u> | <u>117</u> | <u>120</u> |

*Daily average Consumption of Bread and Meat, per head,*

|           | 1840,               | 1841,                | 1842.  |
|-----------|---------------------|----------------------|--------|
| Bread.... | oz. 18              | oz. 16 $\frac{1}{2}$ | oz. 15 |
| Meat..... | oz. 8 $\frac{1}{4}$ | oz. 7 $\frac{3}{4}$  | oz. 8  |

*Weekly average Loss on Bread and Meat, as shewn on taking Stock weekly,*

|             | 1840,        | 1841,        | 1842.         |
|-------------|--------------|--------------|---------------|
| Bread ..... | lbs. 1 oz. 1 | lbs. 1 oz. 5 | lbs. 2 oz. 8  |
| Meat .....  | lbs. 4 oz. 4 | lbs. 3 oz. 1 | lbs. 3 oz. 15 |

**DIETARY**

OF THE THIRD RANK PATIENTS,

*except where specially altered by the Faculty, or by a Weekly Board.*

| Breakfast.                     | Dinner.                          | Supper.                         |
|--------------------------------|----------------------------------|---------------------------------|
| <i>Males.</i>                  |                                  |                                 |
| Bread ..... 6 oz.              | Bread ..... 3 oz.                | Bread,..... 6 oz.               |
| New Milk, boiled.. 1 pt.       | Meat, cooked & boned 4 oz.       | New Milk, boiled.. ½ pt.        |
|                                | Potatoes . . . . . 10 oz.        |                                 |
| <i>Females.</i>                |                                  |                                 |
| Bread, toasted ..... 5 oz.     | Bread..... 3 oz.                 | Bread, toasted and              |
| Tea ..... 1 pt.                | Meat, cooked & boned 4 oz.       | buttered ..... 5 oz.            |
|                                | Potatoes ..... 10 oz.            | Tea ..... ½ pt.                 |
| <i>Males and Females.</i>      |                                  |                                 |
| <i>Sunday.</i> —Roast Beef.    | <i>Wednesday.</i> Boiled Beef.*  | <i>Friday.</i> —Boiled Beef.    |
| <i>Monday.</i> —Boiled Mutton. | <i>Thursday.</i> —Boiled Mutton. | <i>Saturday.</i> —Boiled Beef.* |
| <i>Tuesday.</i> —Boiled Beef.  |                                  |                                 |

\* Or cold meat warmed, with Soup 1 pint, for half the Patients.

An Ox cheek is stewed with the Soup weekly.

Carrots are used occasionally instead of Potatoes.

**WORK DONE BY THE FEMALE PATIENTS,***from January 1st, 1841, to December 31st, 1842.*

Articles made up.

|                          |                            |                            |
|--------------------------|----------------------------|----------------------------|
| Aprons ..... 74          | Napkins ..... 9            | Socks knitted, pair .. 1   |
| Bedticks ..... 2         | Neckerchiefs ..... 44      | Stockings knitted, pairs 3 |
| Caps ..... 76            | Necklace ..... 1           | Ditto footed, pairs .... 2 |
| Chemise ..... 84         | Night gowns ..... 40       | Ditto, marked, pairs.. 25  |
| Dish cloths ..... 45     | Pillow cases ..... 33      | Straw cases ..... 12       |
| Drawers, pairs .... 3    | Pinafores ..... 11         | Strong dresses ..... 2     |
| Dusters ..... 7          | Pockets ..... 5            | Table cloths ..... 13      |
| Flannel petticoats .. 40 | Pocket handkerchiefs... 55 | Top petticoats ..... 51    |
| Flannel waistcoats .. 20 | Shaving cloths ..... 8     | Towels ..... 53            |
| Garters, knitted ... 5   | Sheets, pairs ..... 21½    | Window blinds ..... 7      |
| Gown ..... 1             | Shirts ..... 52            | Work bags ..... 3          |

The Patients are not confined to Needlework or other sedentary employment, when they can be engaged in the open air.

**GROUND, APARTMENTS, BEDS,**

|                          |                           |                          |
|--------------------------|---------------------------|--------------------------|
| Exercising Grounds.. 4   | Single Sleepingrooms.. 48 | Beds, for Patients.. 112 |
| Exercising Galleries.. 6 | Double and treble ditto 6 | Beds, for Attendants 10  |
| Dayrooms ..... 16        | Dormitories ..... 6       | Beds, for Household 8    |

*EXTRACTS FROM THE RULES.*

~~~~~  
BOARDS.

An *Ordinary Board* of the Governors is held Weekly at the Asylum, on Monday, at *One o'clock*.

A *General Board* of the Governors is held Quarterly on the second Wednesday in January, April, July, and October, at *Twelve o'clock*.

ADMISSION OF PATIENTS.

The Ordinary Board regulates the admission of Patients.—The Forms of Admission, with other necessary information, are immediately supplied to applicants, by the Secretary or House-Surgeon.

The House-Surgeon, during the intervals of the Boards, may, on emergency, provisionally admit Patients who have complied with the necessary Forms, subject to the opinion of the Physician.

Where any difficulty occurs in conducting Patients to the Asylum, the Physician may send a confidential Attendant for the purpose; for which no charge is made beyond the expenses incurred.

The following are the usual terms for Board, Lodging, Attendance, and Medical Treatment.

1st Rank	per week	1	1	0
2nd Rank	—————	0	15	0
3rd Rank	—————	0	10	0

Special Contracts may be made for extra Attendants and Diet.

A “Deposit of six weeks’ payment,” and a “Payment in advance up to the next Quarter day,” are required with each Patient on admission.—The Friends may advance for any additional Quarters, if more convenient.—The Quarter Days fall on the first day of January, April, July, and October, respectively.—On the removal or death of any Patient, the amount due to the Institution is deducted, and the surplus returned.

OFFICIAL VISITING.

A “Governors’ Memorandum Book” shall lie upon the Board Room Table, for their remarks at such times as they shall think proper to visit the Asylum.

At each Quarterly General Board the Governors present or some of them, shall be requested to inspect the Asylum, and see every Room and Patient, and report forthwith to the Board.

At each Ordinary Board, one of the Governors shall be appointed Visitor for the week next succeeding, to visit the Asylum daily, if convenient, to see every Patient once at least in the week, to make any inquiries which may seem fit, and to enter his observations in the “Weekly Visitor’s Book;” and no person whatsoever shall interfere to prevent the most minute examination of the Establishment.

OCCASIONAL VISITING.

Persons wishing to visit the Asylum, may be personally introduced by one of the Physicians, Surgeons, or Governors, or by the written order of a Governor; and the House-Surgeon may admit any respectable non-resident of Lincoln to see the Establishment, without a special order.

VISITS OF FRIENDS.

The Rules affecting the admission of the Patients' friends, are appended to each Quarterly Account.

OFFICERS, SERVANTS.

No Officer or person whatsoever employed in this Institution, shall give to, or receive from any Tradesman, Servant, Patient, Stranger, or other person whatsoever, any fee, reward, gratuity, or present, directly or indirectly, for anything done on account of the Asylum, on pain of expulsion; nor bargain with any Patient for the sale, purchase, or exchange of clothing, food, or other article.

BOOKS, ACCOUNTS.

Any Governor may at all times inspect, extract, or copy, any Bills, Accounts, Journals, Registers, Minute-Books, or Documents whatsoever, provided that the names of the Patients shall not be copied: and all Documents, kept by order of the Rules or of any Board, shall be the property of the Institution.

Note. A Key to the Official Books, Bills, Vouchers, &c., is left always in the House, so that they may be accessible to the Governors.

FORM FOR LEGACIES.

Persons disposed to contribute to the Asylum by their last Will, are particularly requested to use the following words.

I give and bequeath to the Treasurer of a Society who call themselves GOVERNORS OF THE LINCOLN LUNATIC ASYLUM, the Legacy or sum of _____, which sum I charge on such part of my personal estate as does not consist of Chattels real, and direct to be paid by my Executors within _____ months after my decease, and applied to the Charitable uses of the said Asylum, for which, on payment, the Treasurer's Receipt shall be a sufficient discharge.

☞ For want of this Form many Charities have lost their Legacies, the Testators having charged them on their *real* instead of their *personal* estate.

Plan of the Lincoln Lunatic Asylum (1843)

REFERENCE.

- | | |
|--|---|
| <p>Attic Story.</p> <p>1. Superior Patients Sleeping Rooms.
2. House Surgeons Sleeping Room.
3. Matrons d.
4. House Porters d.
Chamber Story of the Centre House.
5. Superior Patients Sitting Rooms.
6. House Surgeons Sitting Room.
7. House Servants Sleeping Rooms.
8. Brush Closets (passim).
9. Water Closets (passim).
Ground Floor of the Centre House.
10. Superior Patients Sitting Rooms.
11. Matrons Sitting Room.
12. Attendants Hall and Eating Room.
13. Board Room.
14. Dispensary.
15. Vestibule.
16. Portico.</p> | <p>Wings.</p> <p>17. Orderly Patients Sitting Rooms.
18. d. Exercising Galleries.
19. Disorderly Patients Sitting Rooms.
20. d. Exercising Galleries.
21. Patients Sleeping Rooms.
22. Attendants d.
23. Dormitories under night Watch.
24. Infirmary.
25. Bath Rooms.</p> <p>Grounds.</p> <p>26. Orderly Patients Airing Grounds.
27. Disorderly Patients d.
28. Shrubberies.
29. Gravel Walks.
30. Flagged d.
31. Grass Plots.
32. Seats.
33. Conservatory — 34. Ha-Ha.</p> |
|--|---|

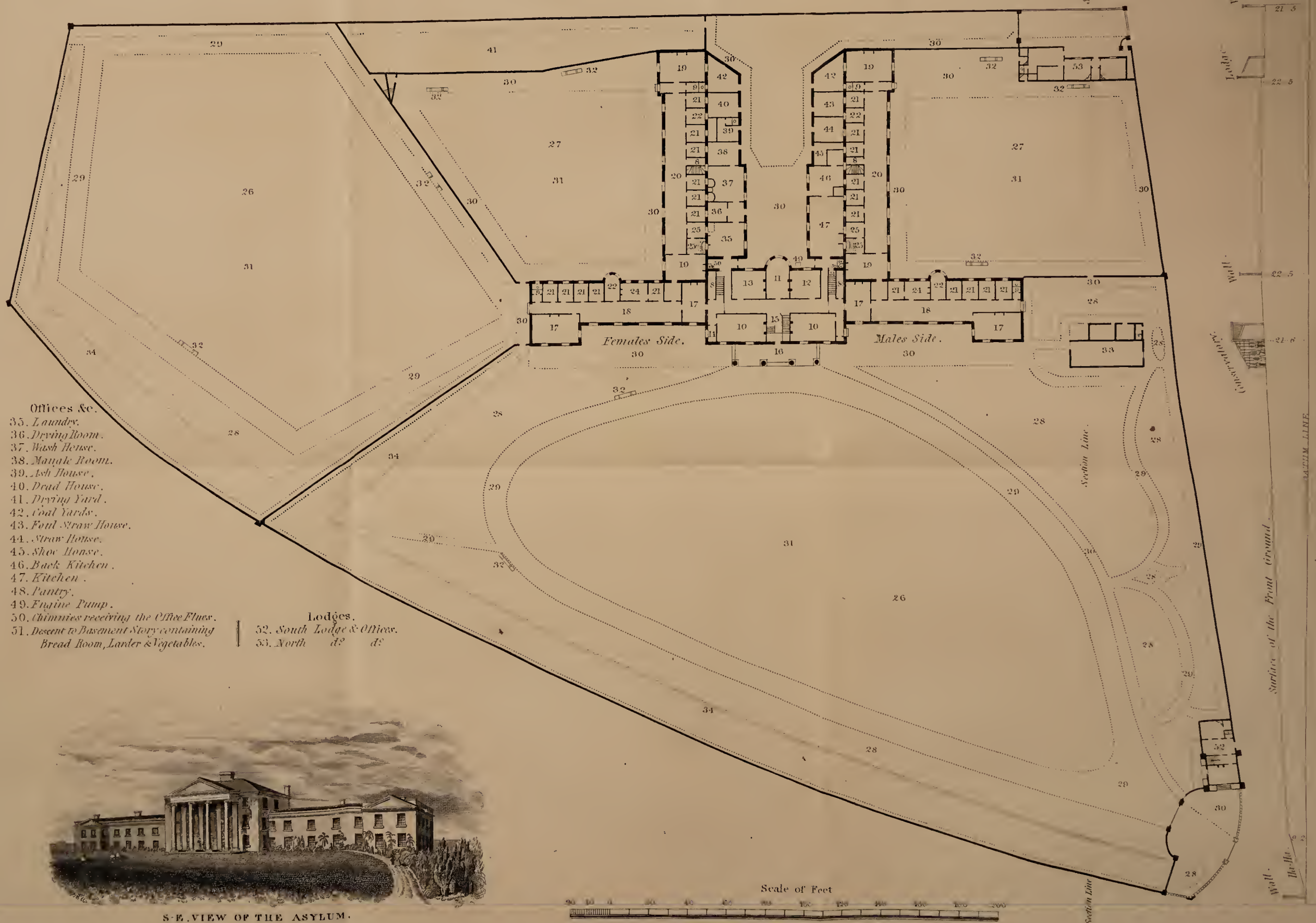
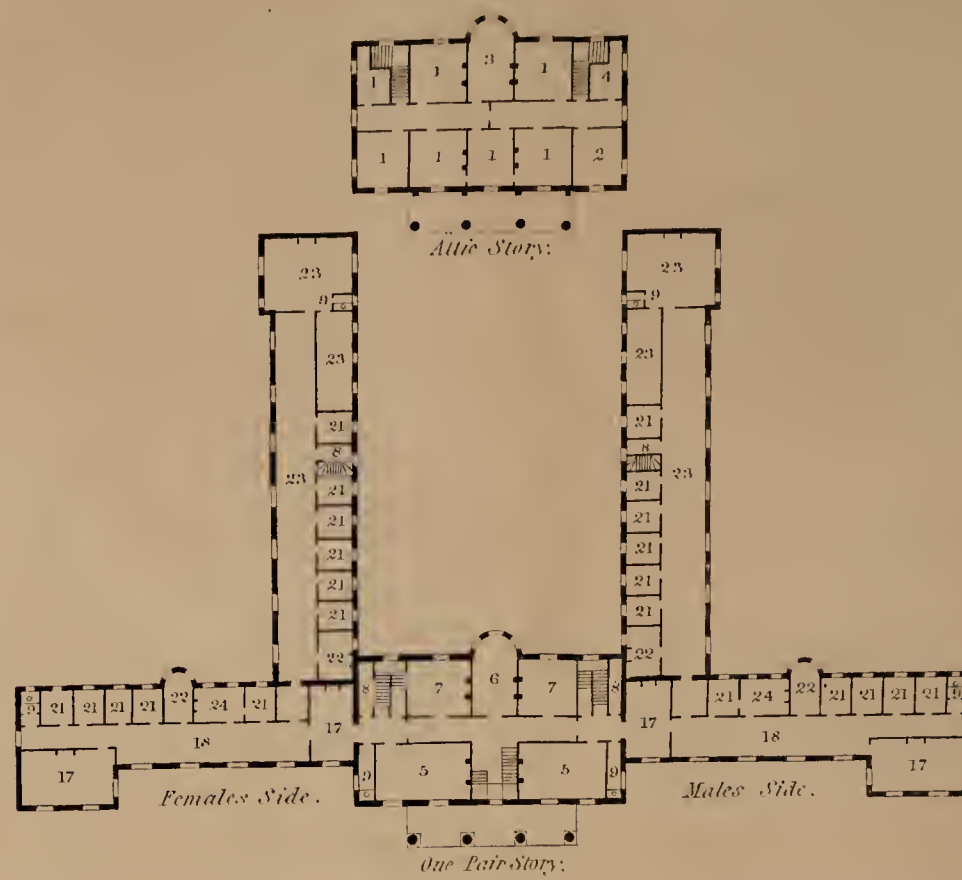

- Offices &c.**
35. Laundry.
36. Drying Room.
37. Wash House.
38. Manure Room.
39. Ash House.
40. Dead House.
41. Drying Yard.
42. Coal Yards.
43. Fowl Straw House.
44. Straw House.
45. Shoe House.
46. Back Kitchen.
47. Kitchen.
48. Pantry.
49. Engine Pump.
50. Chimnies receiving the Office Flues.
51. Descent to Basement Story containing Bread Room, Larder & Vegetables.
- Lodges.**
52. South Lodge & Offices.
53. North d. d.



S.E. VIEW OF THE ASYLUM.

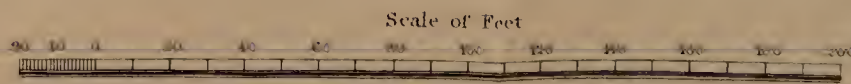

Section of the Ground from North to South.